

# VULCAN DRIFTER RIDERS



[HOME](#) | [FORUM](#)

## Relocate the Reg/Rec (bill h)

1. Remove the reg/rec from the stock bracket, then remove the bracket from the bike...or leave it on and attach a large tool bag like I did. (see [tip for tool bag](#))
2. Cut the wire ties that hold the regulator wires to the frame.
3. Remove the left side floor boards, shifter arms and the engine cover. The regulator wires are inside this area.
4. Reroute the regulator wires to the front of the engine to the radiator.
5. There are mounting tabs on each side of the frame under the radiator.
6. Make a bracket like the one below. (Pic 1) Paint or polish the bracket.
7. Mount the new bracket to the frame tabs with the spacers between the tabs and the bracket...I put the bolts in from the front and used chrome acorn nuts on the back...they ARE visible.
8. Then mount the reg/rec to the front of the bracket...there should be enough wire to have a bit of slack in it.
9. Zip tie the wires where needed then put the engine cover, etc. back on.

Pictures are worth a thousand words.

[Rectifier Bracket Drawings](#) - (bill h)

[Shows Relocated Regulator/Rectifier](#) - Front of bike (Rideon).

© Saftek Inc. 2012

*Not affiliated with Kawasaki. Kawasaki, Vulcan and Drifter are trademarks of Kawasaki.*

### Reg/Rec Relocation Bracket

I used a pc of 2" wide 1/8" thick aluminum stock from Menards. I bought a pc 4' long...for future use! I mounted the Reg/Rec on the front of the brkt... the more air...the better.

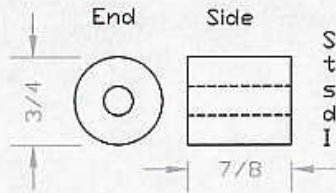

Spacers...one for each side of brkt. They go between the BACK of the frame tabs and the new brkt. This sets the brkt back far enough to use the radiator drain plug. I used pcs from a black 3/4" O.D. solid plastic bar.

Drill hole sizes according to the hole size in the tabs and reg/rec.

